

CONTROLE DE DURETE

Pénétrateurs pour machines d'essai de dureté des métaux

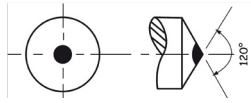

Pénétrateurs ROCKWELL diamant 120°



ERNST

série AT (de AT130 à AT350), TWIN

Code 11 04 00100
11 04 00100UK (+ certificat UKAS)

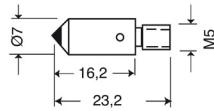

FUTUR-TECH, MATUZAWA, BUEHLER

Code 11 04 01000
11 04 01000UK (avec certificat UKAS)

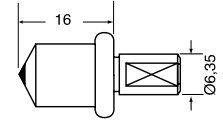

ERNST

série AT (de AT130 à AT350), TWIN

Pénétrateur effilé, utilisation seulement avec buse réduite

Code 11 04 03200
11 04 03200UK (+ certificat UKAS)

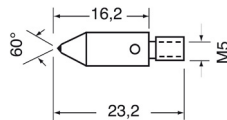

WILSON, GALILEO

Code 11 04 01100
11 04 01100UK (avec certificat UKAS)

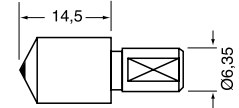

ERNST série NR

FRANCK, STOKVIS - ROCKWELL STANDARD

Code 11 04 00200
11 04 00200UK (avec certificat UKAS)

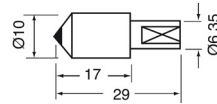

WILSON 1357-A, 1780-A

Code 11 04 01200
11 04 01200UK (avec certificat UKAS)

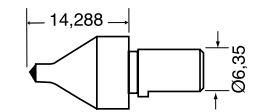

GNEHM

Code 11 04 00300
11 04 00300UK (avec certificat UKAS)

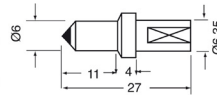

INDENTEC

Code 11 04 01300
11 04 01300UK (avec certificat UKAS)

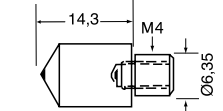

HAUSER

Code 11 04 00400
11 04 00400UK (avec certificat UKAS)

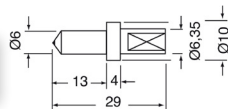

INDENTECAKASHI - MITUTOYO

Code 11 04 01400
11 04 01400UK (avec certificat UKAS)

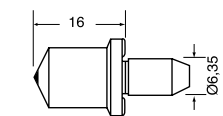

WOLPERT 971

Code 11 04 00500
11 04 00500UK (avec certificat UKAS)

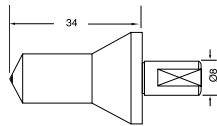

AFFRI RT

Code 11 04 01500
11 04 01500UK (avec certificat UKAS)

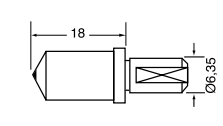

REICHERTER

Code 11 04 00600
11 04 00600UK (avec certificat UKAS)

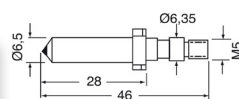

AVERY 6407

Code 11 04 01600
11 04 01600UK (avec certificat UKAS)

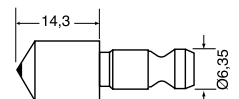

WOLPERT, TESTWELL, VARIO

Code 11 04 00700
11 04 00700UK (avec certificat UKAS)

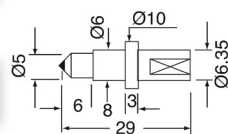

WILSON 1777-C, 1795-N

Code 11 04 01700
11 04 01700UK (avec certificat UKAS)

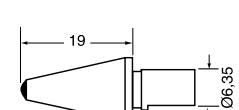

EMCO, ET1

Code 11 04 00800
11 04 00800UK (avec certificat UKAS)

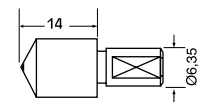

WILSON 1709-N (15 kgf maxi)

Code 11 04 01800
11 04 01800UK (avec certificat UKAS)

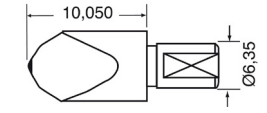

EMCO, NDR012

Code 11 04 00900
11 04 00900UK (avec certificat UKAS)

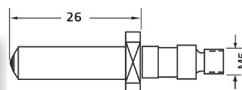

WILSON 1768-N (30 kgf maxi)

Code 11 04 01900
11 04 01900UK (avec certificat UKAS)

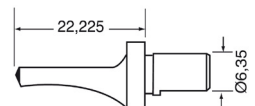

Pénétrateurs pour DUROMETRES PORTABLES ERNST

COMPUTEST SC, SCX

Code 11 01 01680

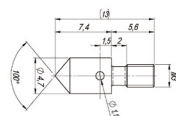

DYNATEST SC, SCX (Pénétrateur ROCKWELL)

Code 11 01 04400

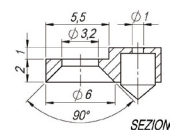

ESATEST HANDY, MTR, MTRX

Code 11 01 04200

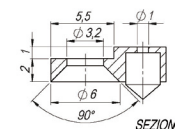

DYNATEST SC, SCX (Pénétrateur BRINELL)

Code 11 01 04500

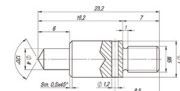

Pénétrateurs pour machines d'essai de dureté des métaux

Pénétrateurs VICKERS diamant 136°

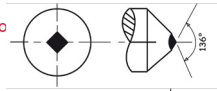

GNEHM

Code	11 04 02200
	11 04 02200UK (avec certificat UKAS)

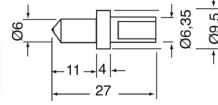

HAUSER

Code	11 04 02300
	11 04 02300UK (avec certificat UKAS)

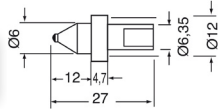

LEITZ

Code	11 04 02400
	11 04 02400UK (avec certificat UKAS)

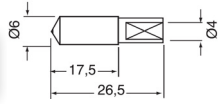

REICHERTER

Code	11 04 02500
	11 04 02500UK (avec certificat UKAS)

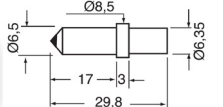

ZWICK

Code	11 04 02600
	11 04 02600UK (avec certificat UKAS)

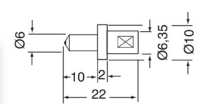

WOLPERT, VARIO, KB

Code	11 04 02700
	11 04 02700UK (avec certificat UKAS)

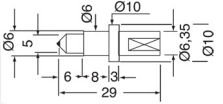

BUEHLER MACROMET

Code	11 04 02800
	11 04 02800UK (avec certificat UKAS)

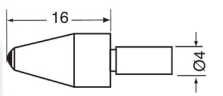

GALILEO, CV, ESE

Code	11 04 02900
	11 04 02900UK (avec certificat UKAS)

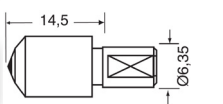

AKASHI, MITUTOYO

Code	11 04 03000
	11 04 03000UK (avec certificat UKAS)

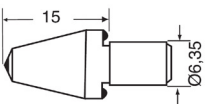

REICHERTER

Code	11 04 03100
	11 04 03100UK (avec certificat UKAS)

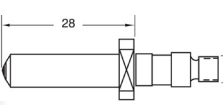

FUTUR-TECH, MATSUZAWA, BUEHLER

Code	11 04 03300
	11 04 03300UK (avec certificat UKAS)

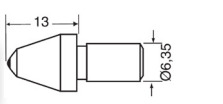

SHIMADZU HMV-M

Code	11 06 00000
	11 06 00000UK (avec certificat UKAS)

SHIMADZU HMV2

Code	11 06 00010
	11 06 00010UK (avec certificat UKAS)

SHIMADZU HSV30

Code	11 06 00020
	11 06 00020UK (avec certificat UKAS)

Pénétrateurs ROCKWELL bille (W) Carbure

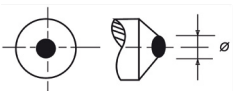

ERNST série NR FRANCK, STOKVIS - "ROCKWELL STANDARD"

Code	Ø Bille (W)
11 01 01200	1/16"
11 01 01210UK	1/16" (+ certificat UKAS)
11 01 05200	1/8"
11 01 05210UK	1/8" (+ certificat UKAS)
11 01 05300	1/4"
11 01 05310UK	1/4" (+ certificat UKAS)
11 01 05400	1/2"
11 01 05410UK	1/2" (+ certificat UKAS)

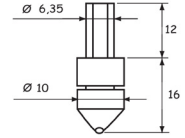

ERNST série AT (de AT130 à AT350), TWIN

Code	Ø Bille (W)
11 01 01500	1/16"
11 01 01510UK	1/16" (+ certificat UKAS)
11 01 05700	1/8"
11 01 05710UK	1/8" (+ certificat UKAS)
11 01 05800	1/4"
11 01 05810UK	1/4" (+ certificat UKAS)

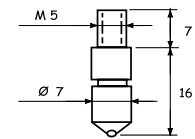

WOLPERT, FUTUR-ETCH

Code	Ø Bille (W)
11 04 04020	1/16"
11 04 04021UK	1/16" (+ certificat UKAS)
11 04 04050	1/8"
11 04 04051UK	1/8" (+ certificat UKAS)
11 04 04070	1/4"
11 04 04071UK	1/4" (+ certificat UKAS)

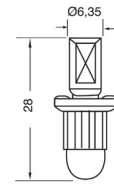

Pénétrateurs BRINELL bille (W)carbure

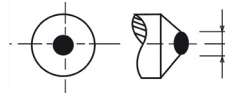

ERNST série NR FRANCK, STOKVIS, WOLPERT, KB "ROCKWELL STANDARD"

Code	Ø Bille (W)
11 01 05500	1 mm
11 01 05500UK	1 mm (+ certificat UKAS)
11 01 01300	2,5 mm
11 01 01300UK	2,5mm (+ certificat UKAS)
11 01 01400	5 mm
11 01 01400UK	5mm (+ certificat UKAS)

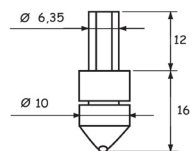

ERNST série AT (de AT130 à AT350), TWIN

Code	Ø Bille (W)
11 01 01600	2,5 mm
11 01 01600UK	2,5mm (+ certificat UKAS)
11 01 01700	5 mm
11 01 01700UK	5mm (+ certificat UKAS)

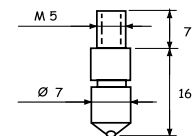

WOLPERT, KB

Code	Ø Bille (W)
11 04 05050	10 mm
11 04 05050UK	10 mm (+ certificat UKAS)

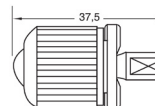

NEWAGE HB-3010

Code	Ø Bille (W)
11 05 00000	2,5 mm
11 05 00000UK	2,5mm (+ certificat UKAS)
11 05 00005	5 mm
11 05 00005UK	5mm (+ certificat UKAS)
11 05 00010	10 mm
11 05 00010UK	10 mm (+ certificat UKAS)

